

Old solution

A complete set for mounting on the wall is delivered as standard.
The set contains:

- 4 pcs of brackets
- all elements for mounting on the wall
- air vent
- blanking plug
- mounting instructions

Mounting sets delivered as standard.

For mounting to the wall a two-piece "sleeve-joint" bracket is used.

The choice of the type of the bracket depends on:

- the shape of the tube (2 versions - straight, curved)
- diameter of the tube (2 versions - $\varnothing 20$ mm and $\varnothing 24$ mm)
- colour of the radiator (2 versions - white and chrome)

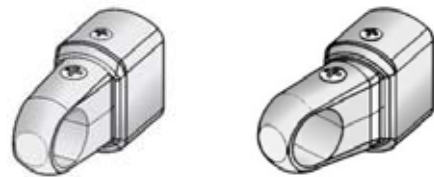

New solution

A complete set for mounting on the wall is delivered as standard.
The set contains:

- 4 pcs of brackets
- all elements for mounting on the wall
- air vent
- blanking plug
- mounting instructions

Mounting sets delivered as standard.

For mounting on the wall a two-piece "thrust" bracket is used.

The choice of the type of the bracket depends on :

- distance between the tubes (2 versions - the first one ranging from 11 to 18 mm, the second one ranging from 19 to 28 mm, see please the table No. 1)
- colour of the radiator (2 versions - white and chrome)



Advantages of the new solution

Considerably easier and quicker mounting
Higher solidity and firmness of the connection between:

- bracket x radiator
- bracket x bracket

Thanks to a special element (position **1**) this solution is universal both for radiators with straight tubes (versions LINEAR and TUBUS) and for radiators with curved tubes (version RONDO).

Product range

KL, KLC, KLCM, KLE, KLCE

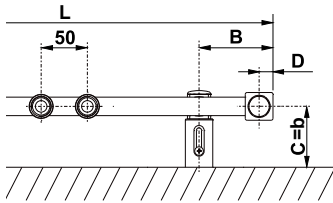

KLP, KLPM

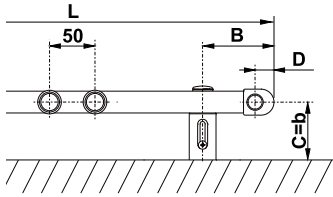

KR, KRC, KRM, KRE, KRCE

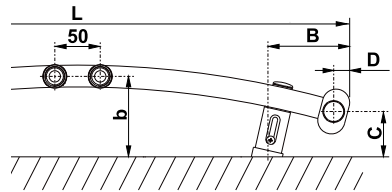

KRP, KRPM

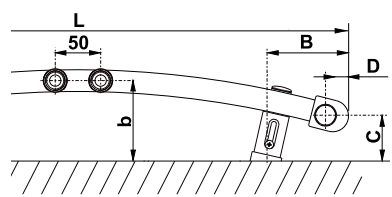

Recommendations

We recommend to place the brackets between 2nd and 3rd tube from above and from below (see the dimension **A**).

We also recommend to tighten the screw (position **2**) gently so that no deformation of the thrusting part of the bracket (position **3**) is caused and so that the cover (position **4**) fits tightly to the thrusting part of the bracket.

We further recommend that the distance between the axis of the bracket and the side edge of the radiator is 80 mm (see the dimension **B**).

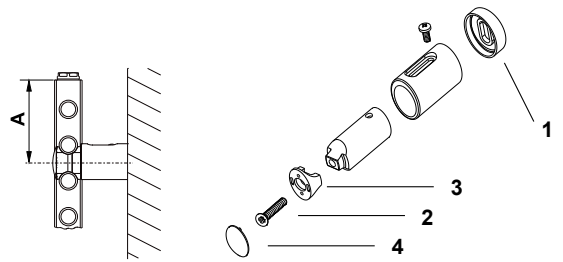

KTM

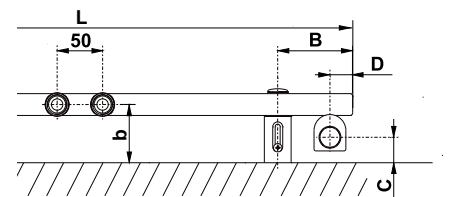

KLCM, KLPM, KRM, KRPM, KTM - Models with bottom middle connection with the connecting pitch 50 mm.

Table No.1

Order code	Type of the "Mounting set"	Version of the radiator KORALUX	Model	Model designation	Diameter of the tube [mm]	A [mm]	B [mm]	C [mm]	D [mm]	b [mm]		
										L = length of the radiator [mm]		
										450	600	750
Z-U510	19-28 white	LINEAR	LINEAR CLASSIC	KLC	20	90	80	68-90	15	-	-	-
			LINEAR CLASSIC-M	KLCM	20	90	80	68-90	15	68-90		
			LINEAR CLASSIC-E	KLCE	20	90	80	68-90	15	-	-	-
			LINEAR PLUS	KLP	24	96	80	68-90	25	-	-	-
			LINEAR PLUS-M	KLPM	24	96	80	68-90	25	68-90		
Z-U511	19-28 chrome	RONDO	RONDO CLASSIC	KRC	20	90	80	61-83	17.5	-	-	-
			RONDO CLASSIC-E	KRCE	20	90	80	61-83	17.5	-	-	-
			RONDO PLUS	KRP	24	96	80	62-84	25	-	-	-
			RONDO PLUS-M	KRPM	24	96	80	62-84	25	90-112	100-122	110-132
Z-U512	11-18 white	LINEAR	LINEAR	KL	24	75	80	66-88	17.5	-	-	-
			LINEAR-E	KLE	24	75	80	66-88	17.5	-	-	-
Z-U513	11-18 chrome	RONDO	RONDO	KR	24	75	80	57-79	17.5	-	-	-
			RONDO-M	KRM	24	75	80	57-79	17.5	86-108	96-118	106-128
			RONDO-E	KRE	24	75	80	57-79	17.5	-	-	-
		TUBUS	TUBUS-M	KTM	24	75	80	30-52	25	66-88		